



## Pattern #12026

Kasota Plinth Block Keyed



## Urethane Formliner

### Materials

- Cut-Lite - Single Use +
- Multi-Lite - 6 Reuses +/-
- Hi-Lite - 12 Reuses +/-
- Duraform - 100 Reuses +/-

### Care and Handling

Keep out of the sunlight and cover when not in use. Keep away from steam, acids, and certain fuels. For further instructions refer to application guide

### Note

We recommend a mockup pour simulating actual job conditions. Refer to application guide for further instructions.

### SECTION VIEW

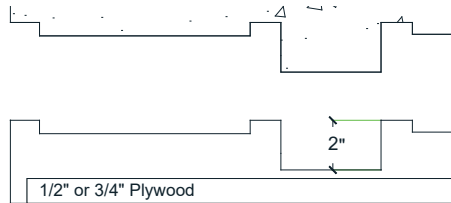

### ELEVATION VIEW

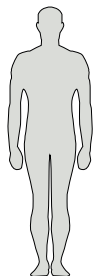
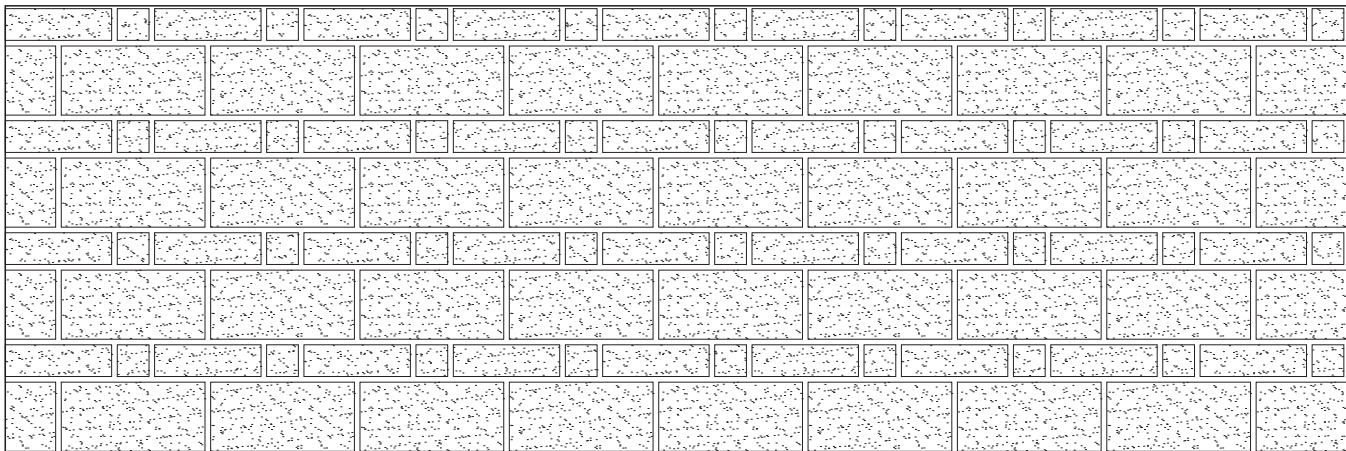



Number of Modules: 8

## Pattern Modules

### MATCHING:

- End to End
- Top to Bottom
- Does Not Match

### ROTATE 180 DEGREES:

- Yes
- No

### KEYED:

- Yes
- No

### STAGGERED PATTERN:

- Yes
- No

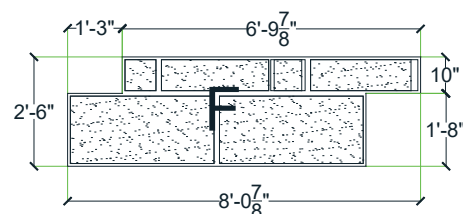
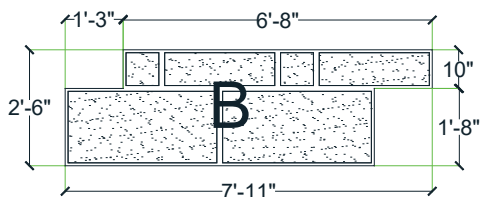
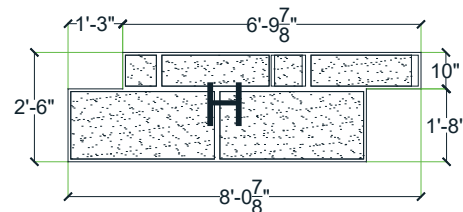
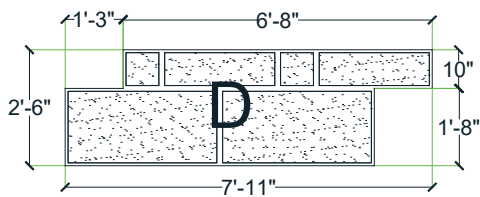
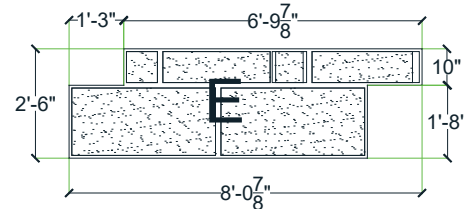
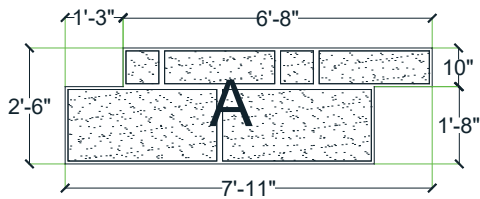
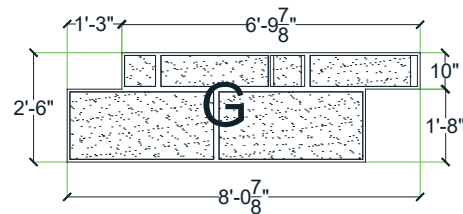
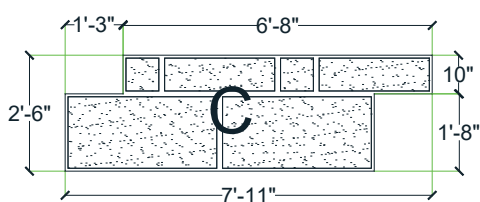



Pattern Layout

Layout #1

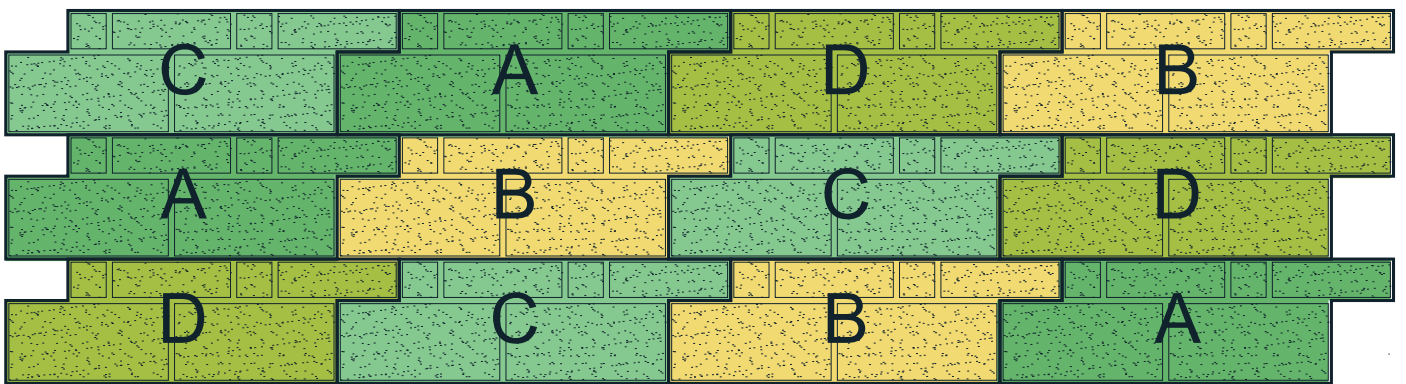

Layout #2

